

POWER & CONTROL

SEASTAR STANDARD TRIM TAB SYSTEM

The intuitive dial controller makes this the simplest trim tab system on the market to plane your boat

FAVORITE PLANED POSITION

PUSH AND HOLD STAR BUTTON

INTUITIVE DIAL CONTROLLER

EASY USER INTERFACE

INTELLIGENT ACTUATOR SYSTEM

LED POSITION INDICATORS



Mobile living made easy.

 **DOMETIC** **OUTDOOR**

A SMART CONTROLLER THAT KEEPS YOU DIALED IN

Tactile Switches Cannot Provide The Precision That Boaters Demand

The INTUITIVE dial makes its super easy to plane your boat quickly by providing instant feedback and a superior user experience.

- The ability to adjust pitch independent of the roll and roll independent of pitch
- Turn the dial in the direction you need to change the roll of the boat so it is level
- Press the bow up or down button to adjust the pitch of the boat to get the desired position
- Favorites button makes it easy to plane your boat with previously set tab position
- 2nd station is an easy addition

Standard Dial Controller



Performance Technology

Leds Indicate Position Of Trim Tabs

Auto Brightness

Will Sense Ambient Light And Adjust Brightness

Bow Down Button

Quickly Move Port And Starboard Tabs To Desired Position

Power Indicator

Indicates There Is Power To The System

Led Will Indicate If There Is An Error

Home Button

Quickly Move Both Tabs To The Home Position

Favorite Button

Hold For 3 Seconds To Save Desired Tab Position

Bow Up Button

Quickly Move Port And Starboard Tabs To Desired Position

Intuitive Technology

Turn Smart Dial To Quickly Level Your Boat

ENGINEERED FOR DURABILITY

ALL ELECTRIC DESIGN REDUCES COMPLEXITY AND INCREASES RELIABILITY.

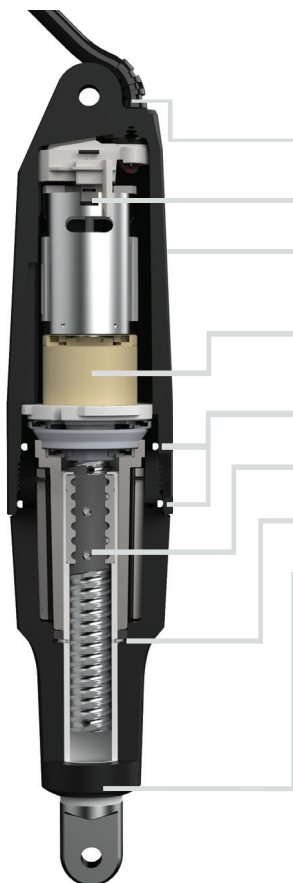

Actuator

- Sealed and potted wiring
- High torque DC motor
- Rugged & stylish housing, simple 2 piece design minimizes possible water ingress points
- Planetary gearbox provides ultra efficient and reliable high load transfer and quiet operation.
- Dual housing seals to prevent leakage
- Free wheeling ball screw technology
- Rear seal in protected bushing area
- Wiper removes particles from shaft and protects rear seal

Trim Tabs



- Heavy duty 12 GA 304 stainless steel tabs, Optional electro polished
- Trim tab kits contain marine grade stainless steel 316 fasteners
- Thick 1/4" hinge pin for added strength
- Heavy duty 14 GA stainless steel hinge to ensure robust tab performance
- Custom tabs available (volume based)
- Tabs available in a variety of standard and edge mount sizes

STANDARD TRIM TAB SCHEMATIC

We've engineered our trim tabs to deliver precise control that offers the boater an intuitive user experience on the water.

- * Wiring diagram for reference only.
- * Sold as a system.

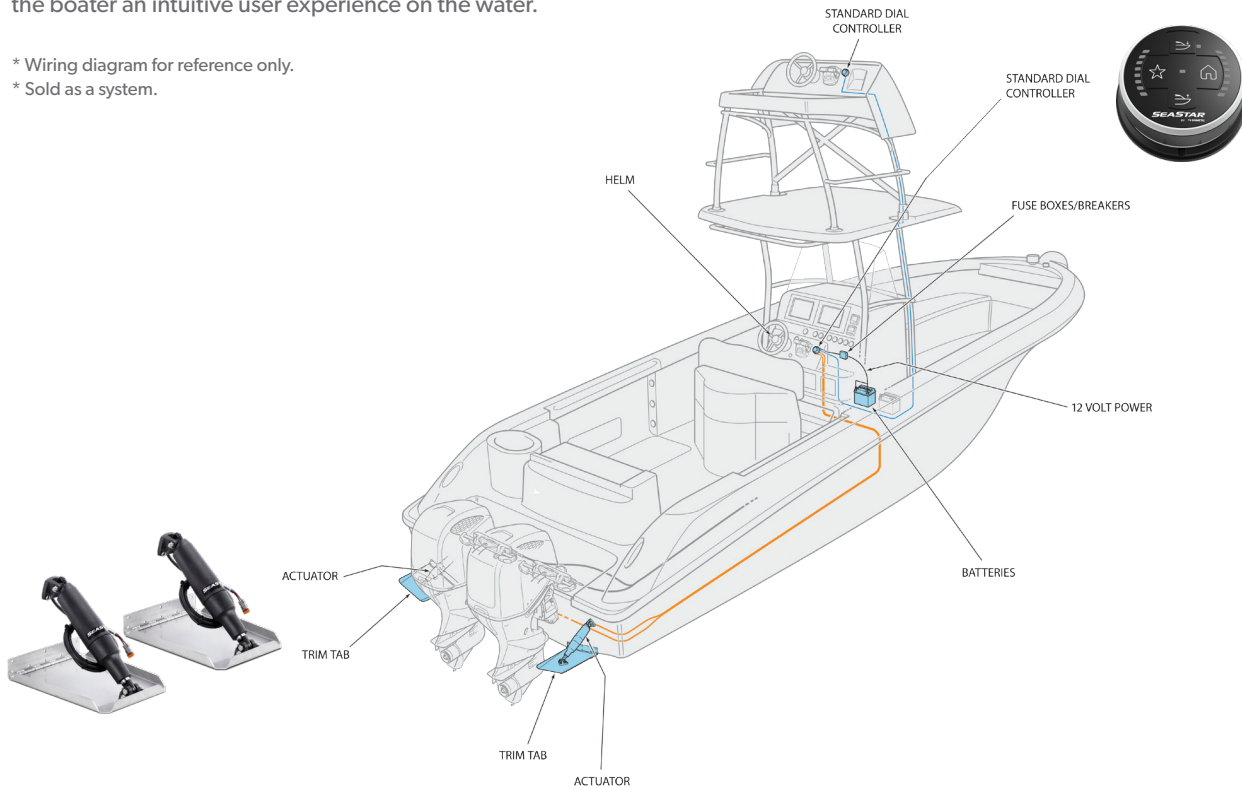

SPECIFICATIONS	SUMMARY
Stroke length	2.25" and 4.25"
Operating voltage	9-16 VDC (SAE J1455)
Maximum Push Load Capability	1000 lbf
Impact Resistance	50G in Z-axis (ABYC P-27 / IEC60068)
Operating temperature	-18 to 77 C (ISO 25197)
Storage temperature	-40 to 85 C (ISO 25197)
Actuator power consumption under typical load	5 A
Actuator water ingress protection	IP66M, IP68M, IP69K (High Pressure Wash Down)
Dial controller water ingress protection	IP56
Tab actuator connections	2pin Deutsch for power (Pos & Neg)
Dial controller connections	1x 2pin Deutsch DTP for power (Pos & Neg) 2x 2pin Deutsch DT to control two actuators 1x 4pin Deutsch DTM for wake-up and second station
Regulatory	American Boat and Yacht Council (ABYC) European Union (EU) recreational craft directive 2013/53/EU (replacing 94/25/EC) CE,
Trim tabs	304 stainless steel, 12 gauge, electro-polished available, and custom sizes/designs available (based on volume)
Note: Subject to change	

Standard Trim Tabs System Includes:
 (Qty 2x Actuators, Controller, Harnesses, 2x Stainless Tabs, Mounting Hardware)

DOMETIC SKU	PART NO	DESCRIPTION
9600049553	STT3103R	Kit, 2.25" Stroke 11.5" P-P Standard Actuator And Controller, 9"X12" Standard Tabs
9600049554	STT3105R	Kit, 2.25" Stroke 11.5" P-P Standard Actuator And Controller, 12"X12" Standard Tabs
9620000076	STT3107R	Kit, 2.25" Stroke 11.5" P-P Standard Actuator And Controller, 12"X9" Standard Tabs
9600049557	STT3205R	Kit, 2.25" Stroke 11.5" P-P Standard Actuator And Controller, 12"X12" Edge Mount Tabs
9600049558	STT3207R	Kit, 2.25" Stroke 11.5" P-P Standard Actuator And Controller, 12"X9" Edge Mount Tabs
9620001321	STT3211R	Kit, 2.25" Stroke 11.5" P-P Standard Actuator And Controller, 12"X18" Edge Mount Tabs
9600049555	STT3131R	Kit, 2.25" Stroke 10" P-P Standard Actuator And Controller, 9"X12" Standard Tabs
9600049556	STT3133R	Kit, 2.25" Stroke 10" P-P Standard Actuator And Controller, 12"X12" Standard Tabs
9600049559	STT3231R	Kit, 2.25" Stroke 10" P-P Standard Actuator And Controller, 12"X12" Edge Mount Tabs
9600049560	STT3233R	Kit, 2.25" Stroke 10" P-P Standard Actuator And Controller, 12"X9" Edge Mount Tabs
9600049561	STT3601R	Kit, 2.25" Stroke 11.5" P-P Standard Actuator And Controller, No Tabs
9600050059	STT3701R	Kit, 4.25" Stroke, 13" P-P Standard Actuators And Dial Controller, Harness, No Tabs

P-P = Pin to pin distance retracted
 Stroke = The distance the shaft extracts
 9x12 = 9 is the chord length and 12 is the hinge width